

# QUANTUM QSS6

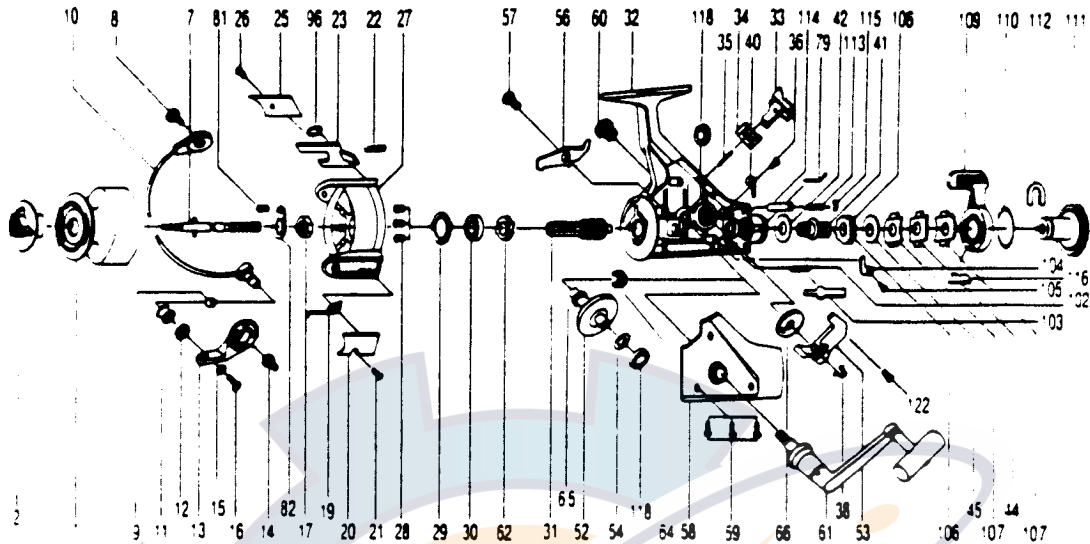

KEY PART NO. NO.	DESCRIPTION	PRICE	KEY PART NO. NO.	DESCRIPTION	PRICE
1 TS321	SPOOL ASSY	8.46	52 SS012	DRIVE GEAR	14.27
2 TS050	DRAG KNOB ASSY	4.53	53 SS025	OSCILLATING SLIDER	3.15
7 TS315	MAIN SHAFT ASSY	8.02	54 RS026	DRIVE GEAR ADJ. WASH	.46
8 SS048	BAIL HOLDER SCREW	1.72	56 SS063	ANTI-REVERSE CLAW	1.43
9 SS016	LINE ROLLER BUSHING	1.66	57 SS089	A/R CLAW SCREW	.80
10 TS347	BAIL ARM ASSY	6.49	58 TS323	BODY COVER ASSY	8.88
11 TS004	LINE ROLLER	1.72	59 RS057	BODY COVER SCREW	.85
12 SS017	BAIL COLLAR	1.27	60 RS073	HANDLE SCREW CAP	1.14
13 TS007	ARM LEVER	1.72	61 TS318	HANDLE ASSY	11.41
14 SS051	ARM LEVER SCREW	1.72	62 SS060	RATCHET GEAR	3.73
15 NB102	BAIL AXLE WASHER	.29	64 NB086	SLIDER SPRING	.39
16 RS108	BAIL SCREW	.58	65 SS001	O/S GEAR PINION	1.66
17 NB006	ROTOR NUT	.85	66 SS053	OSCILLATING GEAR	1.43
19 TS022	BAIL SPRING	.92	79 RS005	BACK CLAW	.98
20 TS087	BAIL SPRING COVER	1.14	81 SS058	ROTOR NUT LOCK SCREW	.58
21 RS085	BAIL SPR. CVR. SCR.	.58	82 SS088	ROTOR NUT LOCK	1.43
22 TS049	KICK LEVER SPRING	.46	96 RS137	S.BEARING CVR. WASH.	.75
23 TS019	KICK LEVER	1.66	102 SS142	M/SHAFT STP. SPR.	.58
25 TS024	KICK LEVER COVER	1.09	103 SS143	M/SHAFT STOPPER	1.27
26 RS037	KICK LVR. CVR. SCR.	.58	104 SS144	STOPPER PLATE	.85
27 TS009	ROTOR	9.17	105 RS145	STOPPER PLATE SCR.	.58
28 RS080	BEARING PLATE SCREW	1.14	106 SS146	SLIDER HOLDER RAT.	1.83
29 SS040	BEARING PLATE	1.43	107 SS147	DRAG SPR. WASH "A"	2.87
30 SS028	BALL BEARING	9.12	109 SS148	BAIT CLICK ACTUATOR	3.44
31 SS011	PINION GEAR	9.57	110 SS149	BAIT DRAG RING	.92
32 TS301	BODY ASSY	11.75	111 SS150	BAIT CLICK DRAG KN.	1.83
33 SS059	ANTI-REVERSE LEVER	.98	112 SS151	BT/CLK DRAG KN RET	1.14
34 SS090	A/R LEVER PLATE	.98	113 SS152	BT/LCK SHAFT SPR.	.46
35 NB091	A/R LEVER PIN	.29	114 SS153	BT/CLK LCK SH SPR	1.14
36 RS067	CLICK CLAM SCREW	.58	115 SS154	E CLIP	.29
38 SS083	OSC. SLDR. STOPPER	3.39	116 SS155	BAIT INSERT	2.00
40 SS068	CLICK CLAM	.85	118 RS157	BALL BEARING	9.12
41 SS104	SLIDER HOLDER	1.27	122 RS161	O/S STOPPER SCREW	.58
42 SS046	DRAG WASHER "C"	.98			
44 SS030	DRAG WASHER "A"	1.14			
45 SS039	DRAG WASHER "B"	.85			

Prices subject to change without notice. Prices do not include postage and handling.

**PLEASE ORDER BY PART NUMBER**

Rev. 11/90

Zebco Division Brunswick Corporation, Box 270, Tulsa, OK 74101 USA 918-836-6681

